

Machine Dimensions and Packaging

General	Regular	Large
Machine Dimensions	1140x110x2504 mm (w x d x h)	1591x1100x2504 mm (w x d x h)
Machine Weight	500 kg (without reels)	700 kg (without reels)
Packaging Dimension		
Wooden crate / cardboard	1350 x 1500 x 2700 mm (w x d x h)	1800 x 1500 x 2700 mm (w x d x h)
Entire wooden crate	1350 x 1550 x 2800 mm (w x d x h)	1800 x 1550 x 2800 mm (w x d x h)
Packaging Weight		
Wooden crate / cardboard	130 kg	180 kg
Entire wooden crate	220 kg	280 kg
Total Weight		
Wooden crate / cardboard	630 kg	880 kg
Entire wooden crate	720 kg	980 kg

Dimension Drawings

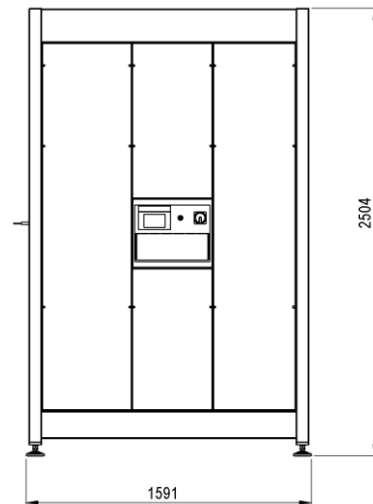
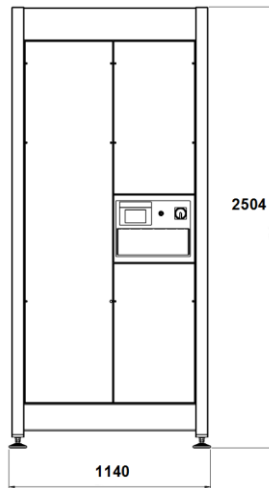
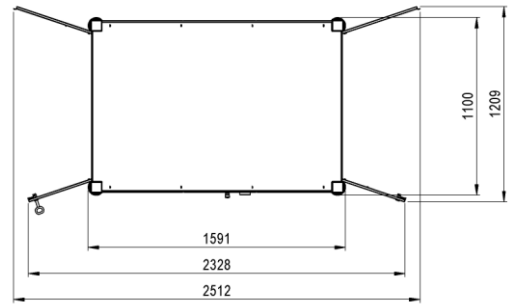
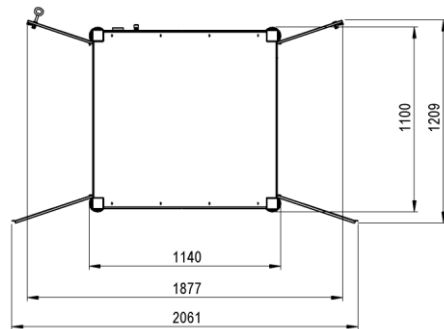

Reel Specifications

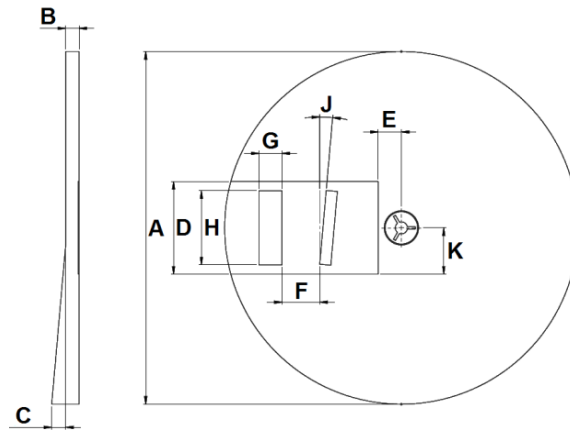

- A Nominal diameter [mm]
- B Reel width [mm]
- C Reel bending downwards [mm]
- D Barcode label area [mm]
- E Barcode label area [mm]
- F Distance between two codes [mm]
- G Barcode height [mm]
- H Barcode label width [mm]
- J Barcode label twist [°]
- K* Reel bending upwards [mm]

Reel Dimensions / Shelf Pitch for 180 mm (7 inches) Reels

Tape width [mm]	A min [mm]	A max [mm]	B min [mm]	B max [mm]	Recomm. Shelf Pitch <1000 g	Recomm. Shelf Pitch >1000 g	Recomm. Shelf Pitch >2000 g
8	100	178	10.5	14.4	25	30	35
12				18.4	30	35	40
16				22.4	35	40	45
24				30.4	45	45	55
32				38.4	50	50	65
44				50.4	65	65	75
56				62.4	75	75	85
C max [mm] <1000 g		C max [mm] >1000 g		C max [mm] >2000 g		Max Reel weight [g]	
2		3		4		3500	
K max [mm] <1000 g		K max [mm] >1000 g		K max [mm] >2000 g		Max Reel weight [g]	
1		1		1		3500	

K* The bending upwards is usually included in the height measurement of the reel. But the bending might be different between the front or back side of the reel, in this case K must not be higher than the mentioned value.

Reel Dimensions / Shelf Pitch for 330/380 mm (13/15 inches) Reels

Tape width [mm]	A min [mm]	A max [mm]	B min [mm]	B max [mm]	Recomm. Shelf Pitch <1000 g	Recomm. Shelf Pitch >1000 g	Recomm. Shelf Pitch >2000 g
8	-	381	10.5	14.4	30	35	35
12				18.4	35	40	40
16				29	45	50	50
24				37	55	55	55
32				45	65	65	65
44				57	75	75	75
56				69	85	90	90
72				89	105	110	110
C max [mm] <1000 g				C max [mm] >1000 g		C max [mm] >2000 g	
6		7		8		3500	
K max [mm] <1000 g		K max [mm] >1000 g		K max [mm] >2000 g		Max Reel weight [g]	
3		3		3		3500	

K* The bending upwards is usually included in the height measurement of the reel. But the bending might be different between the front or back side of the reel, in this case K must not be higher than the mentioned value.

